



## Office Coffee Service Vending Machine

Model : DG-707FM(DSK-622-MA)  
DG-808F3M(3Mixing bowl)  
DG-808F5M(2Mixing bowl)



Main Office : 500-5, Sangdaewon-Dong, Jungwon-Ku,  
Sunnam-City, Kyungki-Do, Korea  
TEL. 82-31-731-3600  
FAX. 82-31-733-1155  
Email. info@venusta.net  
<http://www.venusta.net>

Before performing the connection, make sure that  
the ratings correspond to the power supply voltage

# Features

- 1 Refined design**  
 As the most beautiful vending machine with european style, it show at the best advantage in any places.
- 2 Automatic Micom System**  
 The micom system can be controlled every function, when you press button.
- 3 Mountable water tank**  
 Water tank can be mounted on top of the cabinet to remove inconvenience to supply water appropriately.
- 4 Various menu choice for your taste**  
 Customers can select 1,100kind of tastes by adjusting the volume of raw materials and the amount of the water.
- 5 My cup use for environment protection**  
 My cup use function as a substitute paper cup is realized environment protection reduce by one time cup use.
- 6 Various temperature adjustment system for your taste control.**  
 You can enjoy various taste by easy temperature adjustment controller.

# Table contents

1. Features / Contents.....	1
2. Before using .....	2
3. Description of each section .....	3
4. How to supply water/How to supply materials .....	5
5. How to cup test .....	6
6. How to clean the connection tubes/How to use mountable water bottle .....	7
7. How to install and operate.....	8
8. How to adjust the taste control & water volume(DG-707FM) .....	9
9. How to adjust the taste control & water volume(DG-808F3M) .....	10
10. How to adjust the temporary taste control of the front door(FOR USER) .....	11
11. How to adjust the temporary taste control function Enable & Disable of the front door(FOR USER) .....	12
12. How to set price(DG-707FM) .....	13
13. How to set price(DG-808F3M) .....	14
14. How to check your selling cups(DG-707FM).....	15
15. How to check your selling cups(DG-808F3M) .....	16
16. The function for My cup(Individual cup) use(DG-707FM) .....	17
17. he function for My cup(Individual cup) use(DG-808F3M) .....	18
18. How to the adjustment of water temperature .....	19
19. How to the operation test(DG-707FM / DG-808F3M) .....	20
20. How to the cleaning .....	21
21. How to disassemble parts .....	23
22. How to replace fuse .....	25

# Before using

- 1 Clean the product completely**  
 · Clean inside, outside and raw material barrel completely.
- 2 Establish the product on the flat place with 10cm distance from the wall**  
 · It may cause any noise if installing on the unflat place

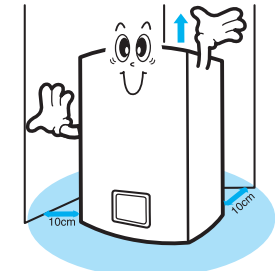
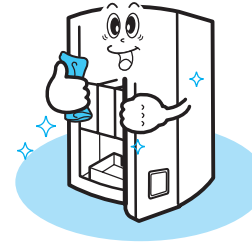

- 3 Put water gutter on the specified position**
- 4 Check the make sure to use the product with 220vol. (option) exclusive power supply**  
 · This product is a 220V(option) exclusive product(Above 2kw of rated capacity)  
 · Use ground-adapted electric outlet necessarily (All of the power supply of this product are grounded)

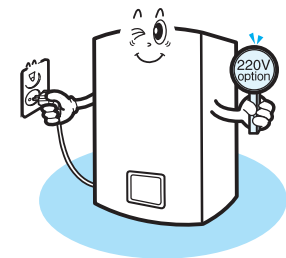
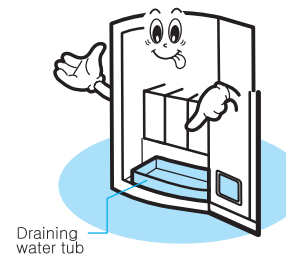

# Accessories

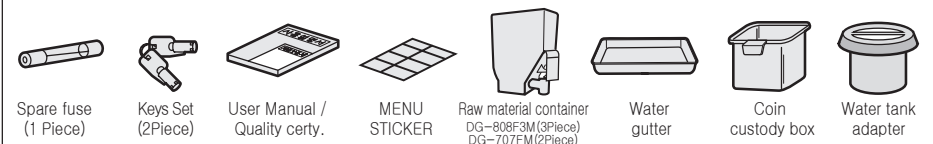



# Description of each section

## The front side

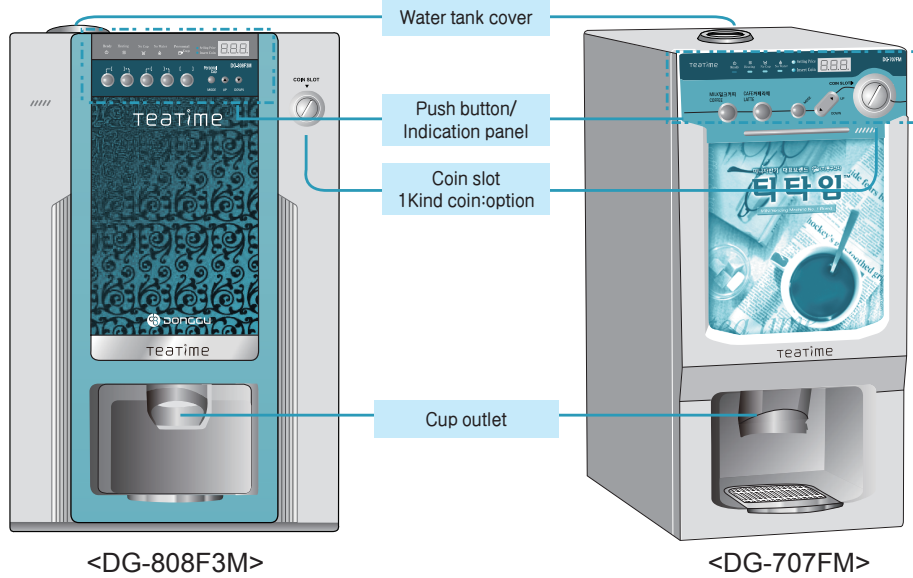

## The rear side

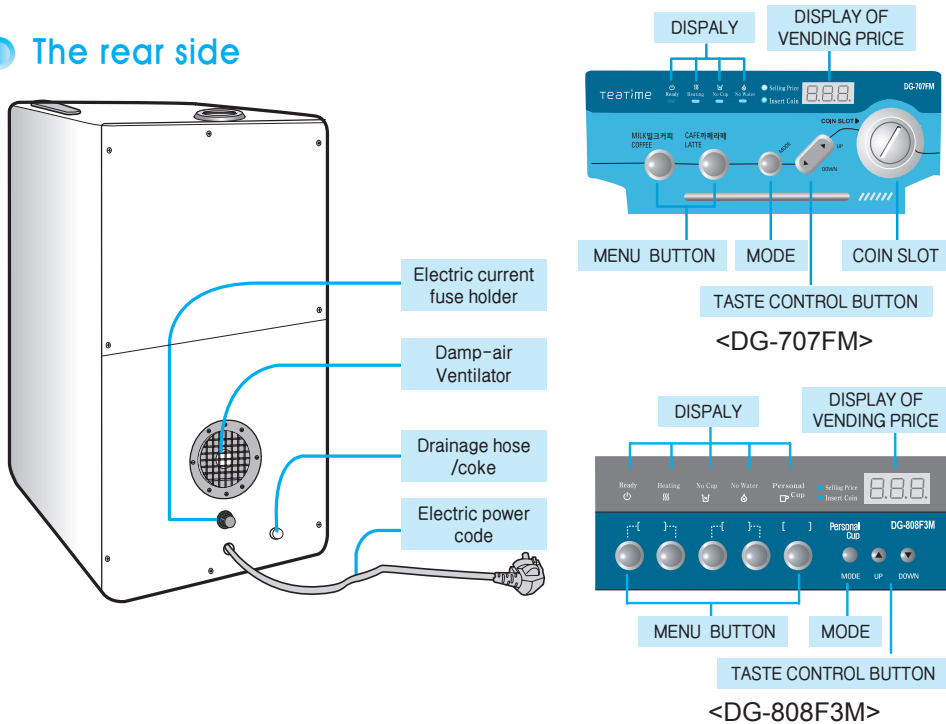

# Description of each section

## Inside the machine

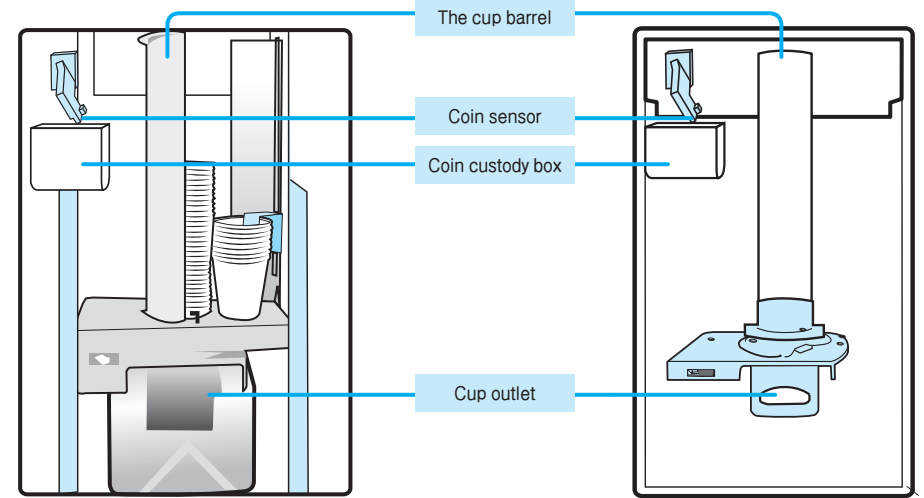

## Internal View

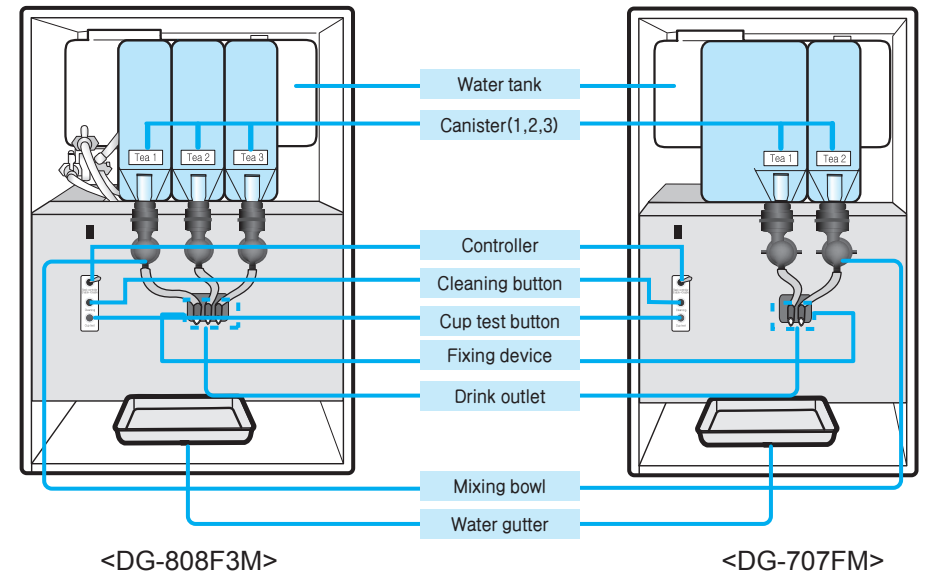

# How to supply water



## How to supply water (INSIDE WATER TANK USING ONLY)

**1** Open the lid of the water tank by twisting the arrow direction as indicated.



**2** Put the water in to the tank using a big kettle



- Precaution**
- Supply the water to reach 3cm distance from the top of the water tank.
  - If the water overflows or gets into the assembly, it may cause the defect of the machine.

# How to supply materials

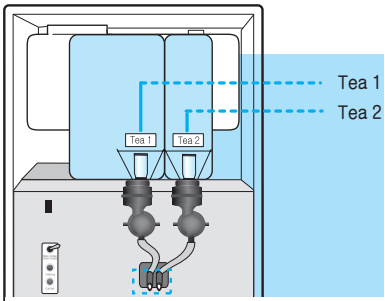

## Disassemble the material barrels at first

- Lift the funnel and takeout.
  - Take out the barrel by lifting the front side of it slightly
- Disassemble in the following from left(Tea1) to right(Tea2)

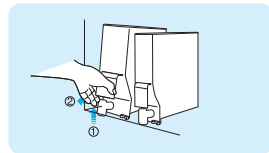

You can prepare the following materials

	Available	Unavailable
Coffee	Mixer coffee(Cafe Latte, Cappuccino, CafeMoca,etc)	
Material	Freshbrew coffee(Linger)	Liquid typecream
TeaMaterial	Citron/Tea	Containedgrain tea
	Cocoa, Powder Milk	soup, stew
	Ginseng tea, Choco	(stickymaterial)

- Reference**
- The maximum volume of the material containers is 4,400g(10.05lbs)for Tea 1 , 2,800g(6.44lbs) for Tea 2, 1,600g(3.61lbs)

# How to cup test

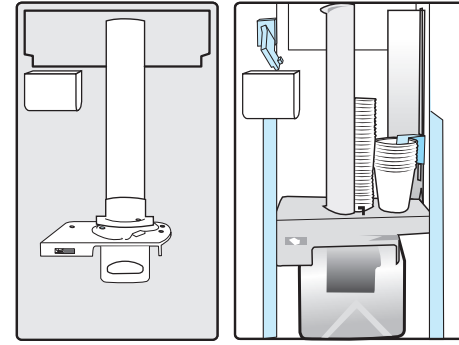

## Put into cup barrel/Cup test

**1** Put the paper cups into cup bucket.

- Put 5~10 cups each time into the barrel for cup sensor to operate moderately

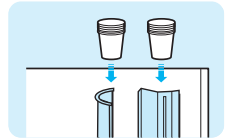

**2** Press the cup test button.

- You can see the paper cup comes out through the outlet with beep sound

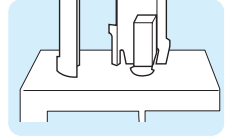

**Precaution**

- Do not use substandard, distorted, deformed or wet cups.
- Do not press the cups to put more cups into the barrel.
- May cause the cup sensor to be out of order.

**Reference**

- Use the only 6.5ounce cups.(195ml standard type)



## How to assemble barrels, and supply materials

**1** Close the lid after putting the raw materials into the container

- When putting raw materials, incline the barrel slightly backward for the materials not to get out of the front hole of the barrel.

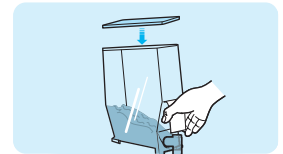

**2** Fix the fixing hole of barrel into the rotating shaft correctly.

- Before assembling containers, make sure that the names of the material shown in a plate adhered to barrel with those of indicating panel.
- Assemble barrels in order
- Tea2 barrel Tea1 barrel(From the left to the right)

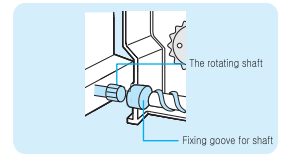

**3** Put the projecting part located in the lower part of barrel into panel groove correctly.  
Put the raw material funnel into the panel hole correctly.

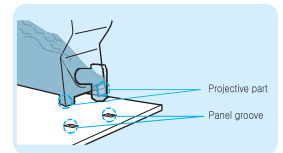

**Precaution**

- Put the raw material into the barrel after removing any moisture from the barrel for the material not to be hardened due to any moisture.

## How to clean the connection tubes

When using the machine for the first time or exception the connection tubes to be clogged due to the hardened materials during operation, press the cleaning button, it will clean them automatically. The cleaning function is only available during power is on.

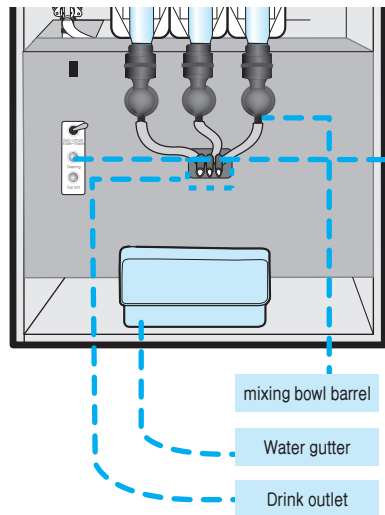

### Cleaning the connection tubes

- 1** Press the cleaning button inside of the door.

  - The coffee or tea material mixing barrel and the connection tubes are cleaned with hot water.

**Reference**

  - Tea material mixing barrel No.1 cleaning → one time Press the cleaning button
  - Tea material mixing barrel No.2 cleaning → two times press the cleaning button for shortly time
  - Tea material mixing barrel No.3 cleaning → three times press the cleaning button for shortly time
  - Tea material mixing barrel No.1,2, 3 in order → one time Press the cleaning button for long time.
- 2** Put the water gutter back, after after remove draining water.

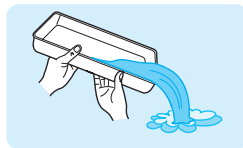
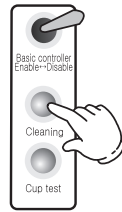

## How to use mountable water bottle

- 1** Open the water tank on the support of the cabinet with the bottom up & put the water bottle on the tank on the support of the cabinet with the bottom up.



- 2** This machine is (small size middle size & large size ) exclusive use spring water bottle only.

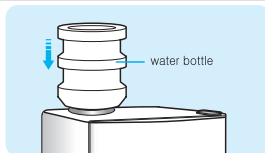

- 3** Water bottle (Middle, Large size) mountable system.

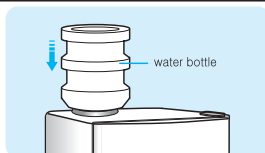

Please notice do not exchange with spring water bottle of kids or infirmity with age. Be careful not pouring or flowering inside of the machine. It may cause electric shock or malfunction.

## How to install and operate

This product is adjusted for the best taste at factory when it comes out. Try to make the drink be tasteful.

### How to set up and choose drink

- 1** First of all, supply water into the tank and put raw materials (See page 5), cup (see page 6)



- 2** Connect the electric plug to correct voltage outlet.

- Use the outlet absolutely having been grounded. (All of power plugs of the machine are grounded)

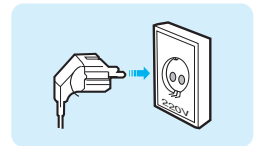

- 3** Turn on the power switch on the right side of the machine.

- The heating lamp will be turned on after buzzer sounds three times and operating lamp will be turned on after 13 minutes pass.



- 4** Press the menu button

- When starting to operate the machine for the first time, the price has a factory set-up at "Free of charge". Therefore, when pressing the button, the drink will be served immediately.



- 5** Take the cup out of the cup service outlet.



### When the following indication signals are displayed

- When "no cup" lamp is changed on supply cups or insert your hand into the outlet and tap 2 or 3 times upward.

- The lamp is turned on when cups remain by almost consuming them.
- The lamp is turned on when the cups are not placed correctly.

- When "no water" lamp is changed on put the water more.

- There may no water in tank, or little water remains.

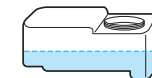

## How to adjust the taste control & water volume(DG-707FM)

This function can be set-up following individual taste.

- 1 Set the Enable /Disable switch in the control box inside the door to Enable
- 2 Press the "MODE" button ONE time of the front door→Display of tea 1 material volume



- 3 Press select Drink button on the front door.
- 4 Please UP or DOWN button on the front door.



- When press tea 2 button →E2.5
- Setting limites of material volume : 0.0~7.5

- 5 When the water volume control, press tea1 button again.
- 6 Please UP or DOWN button on the front door.



Setting limites of water volume : 0.0~9.9

- 7 When finish setting price, please return to "Disable" from "Enable" inside the door. Be keeping your changed numerical value with "beep sound"

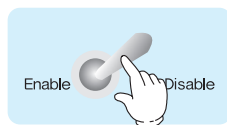

### Ref. inform.when the taste control

- The Max.value of raw material volume is limited of 1.5second of water volume  
For example) When the 6.5second of water volume is limited of 4.5second of material volume.

### Precaution

- Please attention used to "Water volume adjustment valve" because this be caused by drop the quality of accumulation etc.,
- Adjust the volume of water with volume adjustment valve.
- The volume adjustment valves are in the right and left sides of the built-in water tank in the product.
- Turn it left to decrease water volume and turn it right to increase water volume.

## How to adjust the taste control & water volume(DG-808F3M)

This function can be set-up following individual taste.

- 1 Set the Enable /Disable switch in the control box inside the door to Enable
- 2 Press the "MODE" button ONE time of the front door→Display of tea 1 material volume



- 3 Press select Drink button on the front door.
- 4 Please UP or DOWN button on the front door.



- When press tea 2 button →E2.5
- Setting limites of material volume : 0.0~7.5

- 5 When the water volume control, press tea1 button again.
- 6 Please UP or DOWN button on the front door.



Setting limites of water volume : 0.0~9.9

- 7 When finish setting price, please return to "Disable" from "Enable" inside the door. Be keeping your changed numerical value with "beep sound"

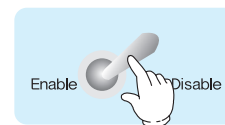

### Ref. inform.when the taste control

- The Max.value of raw material volume is limited of 1.5second of water volume  
For example) When the 6.5second of water volume is limited of 4.5second of material volume.

### Precaution

- Please attention used to "Water volume adjustment valve" because this be caused by drop the quality of accumulation etc.,
- Adjust the volume of water with volume adjustment valve.
- The volume adjustment valves are in the right and left sides of the built-in water tank in the product.
- Turn it left to decrease water volume and turn it right to increase water volume.

## How to adjust the temporary taste control of the front door(FOR USER)

(DG-707FM / DG-808F3M)

- 1 Set the Enable /Disable switch in the control box inside the door to Enable

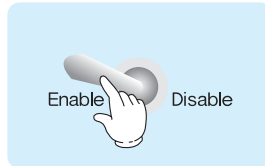

Amount indicator ---

- 2 Press the "MODE" button TWO times of the front door.



Amount indicator t0.2

- 3 Press ("▲" "▼")the UP,DOWN button at the right of MENU button on the front door.(When the press UP button 2times)

The drink volume can be control from Min. t0.1 to Max t0.5



Amount indicator t0.4

- 4 When finish setting price, please return to "Disable" from "Enable" inside the machine.  
Be keeping your changed numerical value with "beep sound"

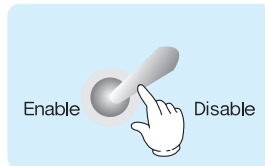

## How to adjust the temporary taste control function Enable & Disable of the front door(FOR USER) (DG-707FM / DG-808F3M)

- 1 Set the Enable /Disable switch in the control box inside the door to Enable

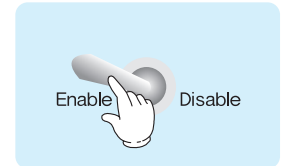

Amount indicator ---

- 2 Press the "MODE" button THREE times of the front door.  
At this time is displayed the setting value.



Amount indicator ENA

- 3 Press ("▲" "▼")the UP,DOWN button at the right of MENU button on the front door.

- \*dls :Disable of temporary taste control function
- \*EnA : Enable of temporary taste control function



Amount indicator dIS

- 4 When finish setting price, please return to "Disable" from "Enable" inside the machine.  
Be keeping your changed numerical value with "beep sound"

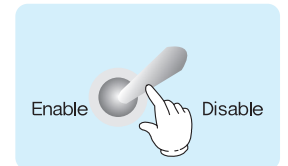

## How to set price(DG-707FM)

- 1 Set the Enable /Disable switch in the control box inside the door to Enable.

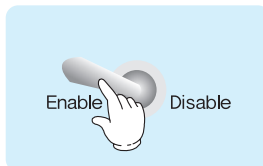

Amount indicator ---

- 2 Press the "MODE" button FOUR times of the front door. Press the menu button , the Vending price of tea1 & tea2 can be setting each menu.



Amount indicator 000

- 3 Press ("▲" "▼")the UP,DOWN button at the right of MENU button on the front door.

\*The vending price setting can be from 0 to 9piece coin.



Amount indicator 200

- 4 When finish setting price, please return to "Disable" from "Enable" inside the door. Be keeping your changed numerical value with "beep sound"

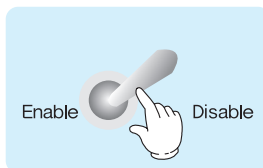

## How to set price(DG-808F3M)

- 1 Set the Enable /Disable switch in the control box inside the door to Enable.

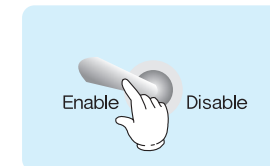

Amount indicator ---

- 2 Press the "MODE" button FOUR times of the front door. Press the menu button , the Vending price of tea1 ,tea2 & tea3 can be setting each menu.



Amount indicator 000

- 3 Press ("▲" "▼")the UP,DOWN button at the right of MENU button on the front door.

\*The vending price setting can be from 0 to 9piece coin.



Amount indicator 200

- 4 When finish setting price, please return to "Disable" from "Enable" inside the door. Be keeping your changed numerical value with "beep sound"

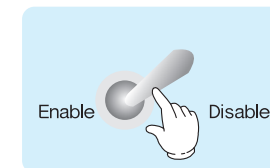

# How to check your selling cups(DG-707FM)

1 Set the Enable /Disable switch in the control box inside the door to Enable.

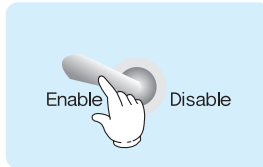

Amount indicator ---

2 Press the "MODE" button FIVE times of the front door.



Amount indicator AC1

3 Press the drink menu button

- \*When you press another Menu button, is displayed selling cups each menu.
- \*Maximum display is to 999,999,999



Amount indicator 223

4 When finish setting price, please return to "Disable" from "Enable"  
Be keeping your changed numerical value with "beep sound"

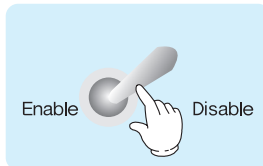

# How to check your selling cups(DG-808F3M)

1 Set the Enable /Disable switch in the control box inside the door to Enable.

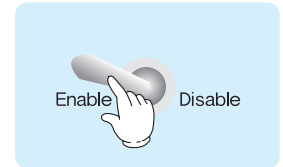

Amount indicator ---

2 Press the "MODE" button FIVE times of the front door.



Amount indicator 123

3 Press the drink menu button

- \*When you press another Menu button, is displayed selling cups each menu.
- \*Maximum display is to 999,999,999

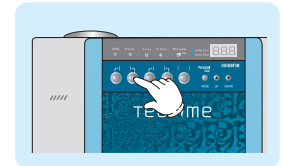

Amount indicator 223

4 When finish setting price, please return to "Disable" from "Enable"  
Be keeping your changed numerical value with "beep sound"

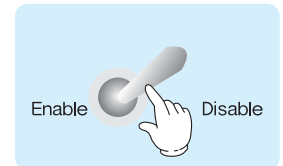



## The function for My cup(Individual cup) use(DG-707FM)

- 1 Set the Enable /Disable switch in the control box inside the door to Enable.

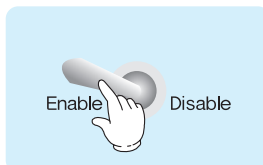

Amount indicator ---

- 2 Press the "MODE" button SIX times of the front door.



Amount indicator AC1

- 3 Press ("▲" "▼")the UP,DOWN button at the right of MENU button on the front door.

- \*AC1 : AUTOMATIC PAPER CUP DROP FUNCTION
- \*AC2 : INDIVIDUAL CUP FUNCTION(PAPER CUP IS NOT DROP)



Amount indicator AC2

- 4 When finish setting price, please return to "Disable" from "Enable"  
Be keeping your changed numerical value with "beep sound"

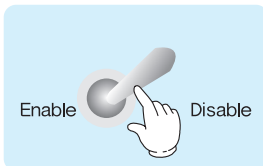

## The function for My cup(Individual cup) use(DG-808F3M)

- 1 Set the Enable /Disable switch in the control box inside the door to Enable.

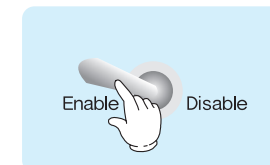

Amount indicator ---

- 2 Press the "MODE" button SIX times of the front door.



Amount indicator AC1

- 3 Press ("▲" "▼")the UP,DOWN button at the right of MENU button on the front door.

- \*AC1 : AUTOMATIC PAPER CUP DROP FUNCTION
- \*AC2 : INDIVIDUAL CUP FUNCTION(PAPER CUP IS NOT DROP)

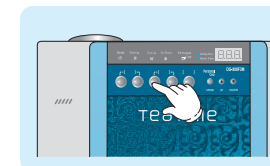

Amount indicator AC2

- 4 When finish setting price, please return to "Disable" from "Enable"  
Be keeping your changed numerical value with "beep sound"

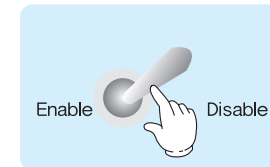

### INDIVIDUAL CUP FUNCTION

- This function is temporary function for individual cup without Paper cup drop.
  - This function can be operated ,AC1 setting only.
1. Press the Individual Cup(mode)button.
  2. Please put down Individual CUP on the cup stand.
  3. Back to "Ready" after drink service.



## How to the adjustment of water temperature

### (DG-707FM / DG-808F3M)

- 1 Set the Enable /Disable switch in the control box inside the door to Enable.

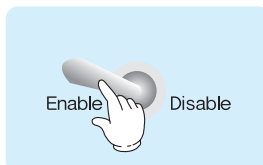

Amount indicator ---

- 2 Press the "MODE" button SEVEN times of the front door.

\*At this time is displayed the setting value of water temperature  
\*You can adjust from 50°C to 98°C



Amount indicator 98c

- 3 For example When you set up 96°C,

\*Press the DOWN button "▼". TWO times of the front door.  
\*When the temperature up, Please Press UP button "▲".



Amount indicator 96c

- 4 When finish setting price, please return to "Disable" from "Enable"  
Be keeping your changed numerical value with "beep sound"

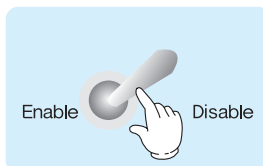

## How to the operation test(DG-707FM / DG-808F3M)

- 1 Set the Enable /Disable switch in the control box inside the door to Enable.

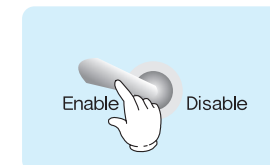

Amount indicator ---

- 2 Press the "MODE" button EIGHT times of the front door.

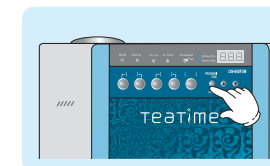

Amount indicator 1st

- 3 Press the Menu button one time long.

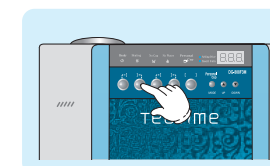

Amount indicator 223

- 4 All kinds of menu is operated 1times successively.

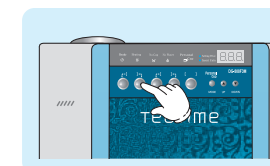

Amount indicator 223

- 5 When finish setting price, please return to "Disable" from "Enable"  
Be keeping your changed numerical value with "beep sound"

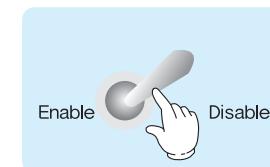

# How to the cleaning

## Inside water tank

Remove fur stacked inside water tank with soft sponge.

- Clean it over two times per one month

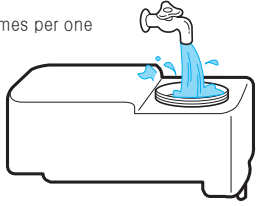

## Canister

Rub it with soft sponge after soaking it in the water to make material become soft

- Reassemble it after drying the water completely.
- Clean it over once per one month



## Draining gutter

After casting away the water, soap it into the water bowl and wash it with water.

- After removing water completely, place it back in the specified position.
- Make sure to insert tube.
- Clean it once per one day.

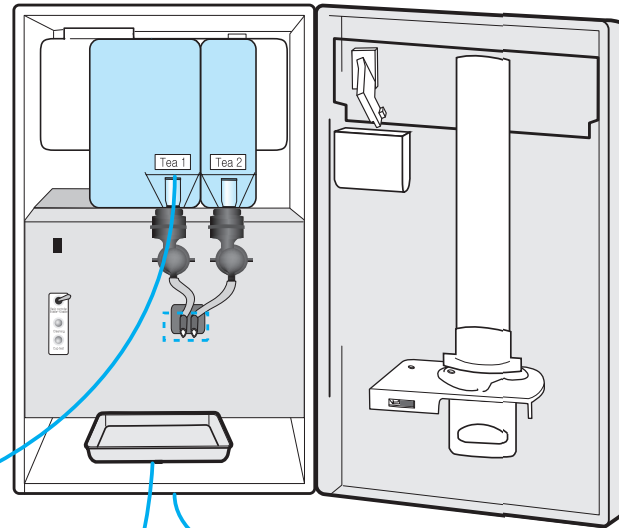

## Mixing bowl

Wash it with soft sponge gourd after soaping it in the water to make hardened material become soft.

- After removing water completely, place it back in the specified position.
- Clean it once per one day.



## Cup outlet

Rub it with dried towel.

- Remove the remaining water with dried towel.
- Clean it once per one day.



## Fan cover of damp-air ventilator

After removing the powder material and dust, clean it in the water and remove water.



## Damp-air ventilating fan

Rub it with wet towel, after shaking of material powder and dust with a brush.

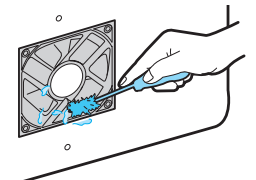

# How to disassemble parts

## ● How to disassemble the mixing bowl

1 Hold the canister with both fingers and remove it by lowering and pulling it upward part "A"

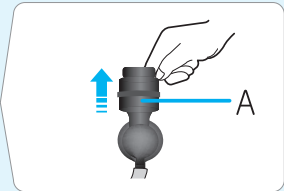

2 After remove "A" part, Turn off upward part "B".

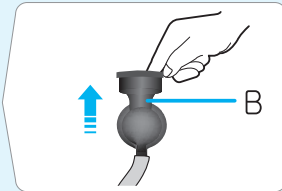

3 Remove the mixing part in the direction to an arrow



4 Remove Drink outlet hose & Mixing bowl

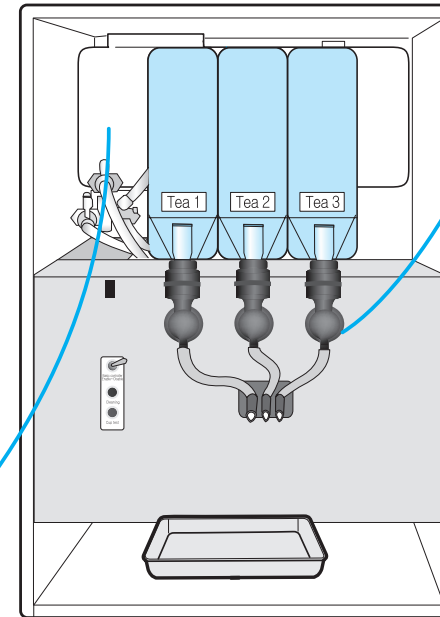
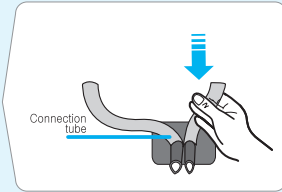

## ● How to disassemble the water tank

1 Pull the draining hose of the rear side and remove the lid.

- The water in the tank is drained completely.
- Turn the power off after draining water.
- Be careful hot water.

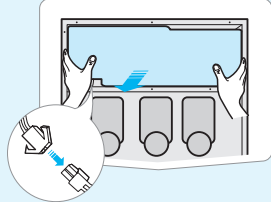

3 Loosen screws on the rear panel and push the water tank and then, disconnect and pull it out.

2 Disconnect the rear side cover with + type screw driver.

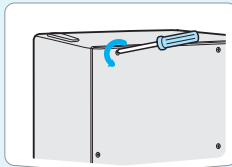

**Precaution** While draining water, be careful of hot water because hot water (above 90°C) gets drained from the beginning.

## ● How to disassemble fan cover of damp – Air ventilator (bottom of the rear panel)

Please press a head of on pressing "A"

- While the damp air inside the product goes out through the damp air ventilator the moisture and dust materials may be mixed and it makes them contaminate.
- So disassemble and clean the fan cover and the ventilating fan.

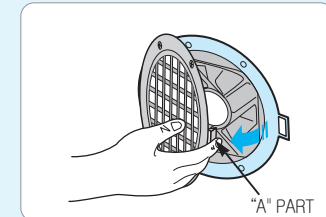

# How to replace fuse

When excessive current flows, a fuse will be broken to cut off the power supply.  
 When a fuse is broken, put new fuse in (Same spec. one with spare fuse only.) and replace the broken one with the new one.  
 \*Fuse is not a item of the after sales service.

## Replace fuse

1 When replacing fuse, must be disconnect disconnect the power plug.

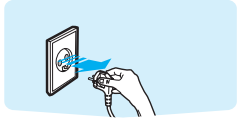

2 Open the fuse holder

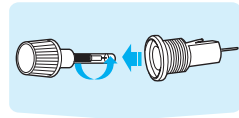

3 Remove the broken fuse and insert the new one.

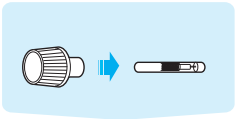

4 Close the fuse holder.

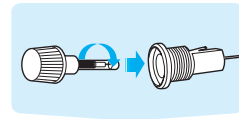

## Specification

Model	DG-707FM	DG-808F3M
Power supply	220(110)V50/60Hz(Export standard spec. is negotiable)	
Consumption power	818W	
Overheating prevention function	Bimetal system(Turn off to 115°C)	
Boiler tank	1,600ml	
Built in Water tank	2,700ml	4,500ml
Coin Mechanism	Option	
Raw material canister	2 Kinds (Tea 1, Tea2)	3 Kinds (Tea 1, Tea2, Tea3)
Indication System	LED & FND	
Control system	MICOM(8K/B Micro Control System)	
Net Weight	16.5kgs	24kgs
Gross Weight	18.5Kgs	25.5kgs
Dimension	630(H) X 300(W) X 483(D)mm	650(H) X 450(W) X 490(D)mm

# MEMO